

Maximum Ratings (Ta=25 Unless otherwise specified

PARAMETER	SYMBOL	UNIT	YBSML8008
Device marking code			YBSML8008
Maximum Repetitive Peak Reverse Voltage	VRM	V	800
Maximum RMS Voltage	VRMS	V	560
Maximum DC blocking Voltage	VDC		
	o	A	8.0
Forward Surge Current (Non-repetitive) @60Hz Half-sine wave, 1 cycle, Tj=25	IFSM	A	250
Forward Surge Current (Non-repetitive) @1ms, square wave, 1 cycle, Tj=25			500
Current squared time @1ms t 8.3ms Tj=25 Rating of per diode	I²t	A²s	259.4
Storage temperature	Tstg		-55 ~ +150
Junction temperature	Tj		-55 ~ +150

Electrical Characteristics Ta=25 Unless otherwise specified

PARAMETER	SYMBOL	UNIT	TEST CONDITIONS	Min	Typ	Max
Instantaneous forward voltage drop per diode	VF	V	IFM=4.0A	0.7	0.875	0.92
DC reverse current at rated DC blocking voltage per diode	IR	µA	Tj=25	-	0.18	5
			Tj=125	-	42	100
Junction capacitance	Cj	pF	Measured at 1MHz and Applied Reverse Voltage of 4.0 V.D.C	35	74	150



Thermal Characteristics T_a



Outline Dimensions

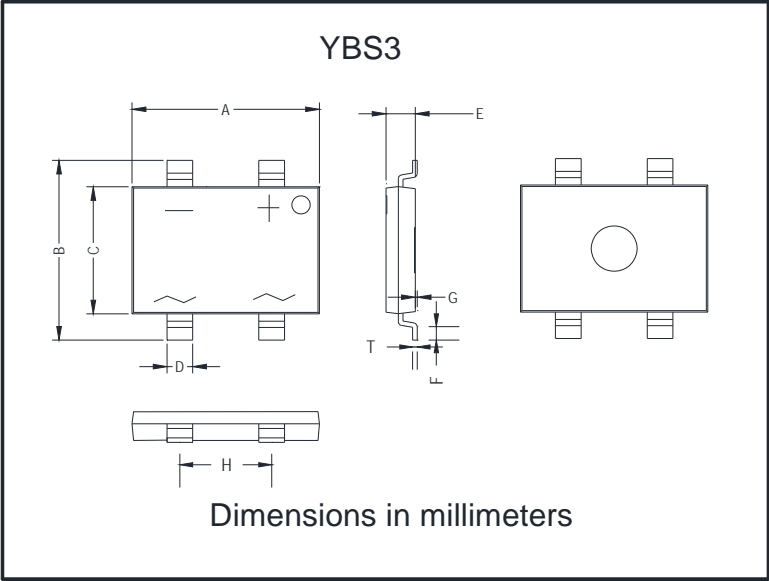

YBS3		
Dim	Min	Max
A	10.00	10.40
B	9.70	10.10
C	6.80	7.20
D	1.3	1.5
E	1.4	1.8
F	0.5	1.1
G	0	0.15
H	4.9	5.1
T	0.20	0.30

Suggested pad layout

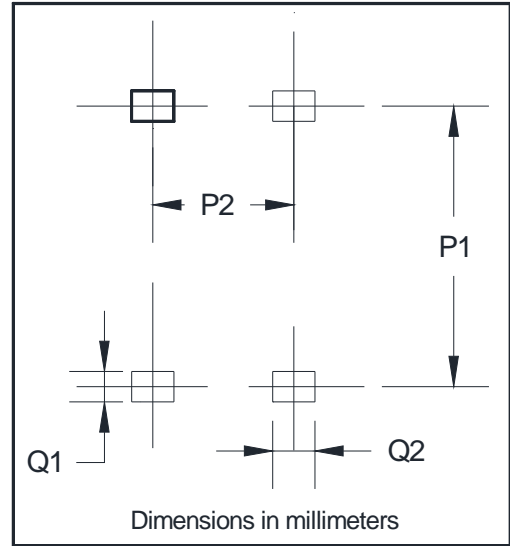

YBS3	
Dim	Min
P1	9.25
P2	5.00
Q1	1.00
Q2	1.5



Disclaimer

The information presented in this document is for reference only. Yangzhou Yangjie Electronic Technology Co., Ltd. reserves the right to make changes without notice for the specification of the products displayed herein to improve reliability, function or design or otherwise.

The product listed herein is designed to be used with ordinary electronic equipment or devices, and not designed to be used with equipment or devices which require high level of reliability and the malfunction of which would directly endanger human life (such as medical instruments, transportation equipment, aerospace machinery, nuclear-reactor controllers, fuel controllers and other safety devices), Yangjie or anyone on its behalf, assumes no responsibility or liability for any damages resulting from such improper use of sale.

This publication supersedes & replaces all information previously supplied. For additional information, please visit our website [http:// www.21yangjie.com](http://www.21yangjie.com) , or consult your nearest Yangjie's sales office for further assistance.